

CONTENTS OF SHEET
PLOT AREA, R.G. AREA STATEMENT, AMENITY AREA STATEMENT.

This Plans are Approved to the Conditions Mentioned in the Commencement Certificate Issued by this office bearing Certificate No. CIDCO/NAINA/Panvel/Kolkhe/BP-00112/ACC/2026/1553 Date- 21/04/2026

AMENITY CALCULATION FOR SALE & RENTAL

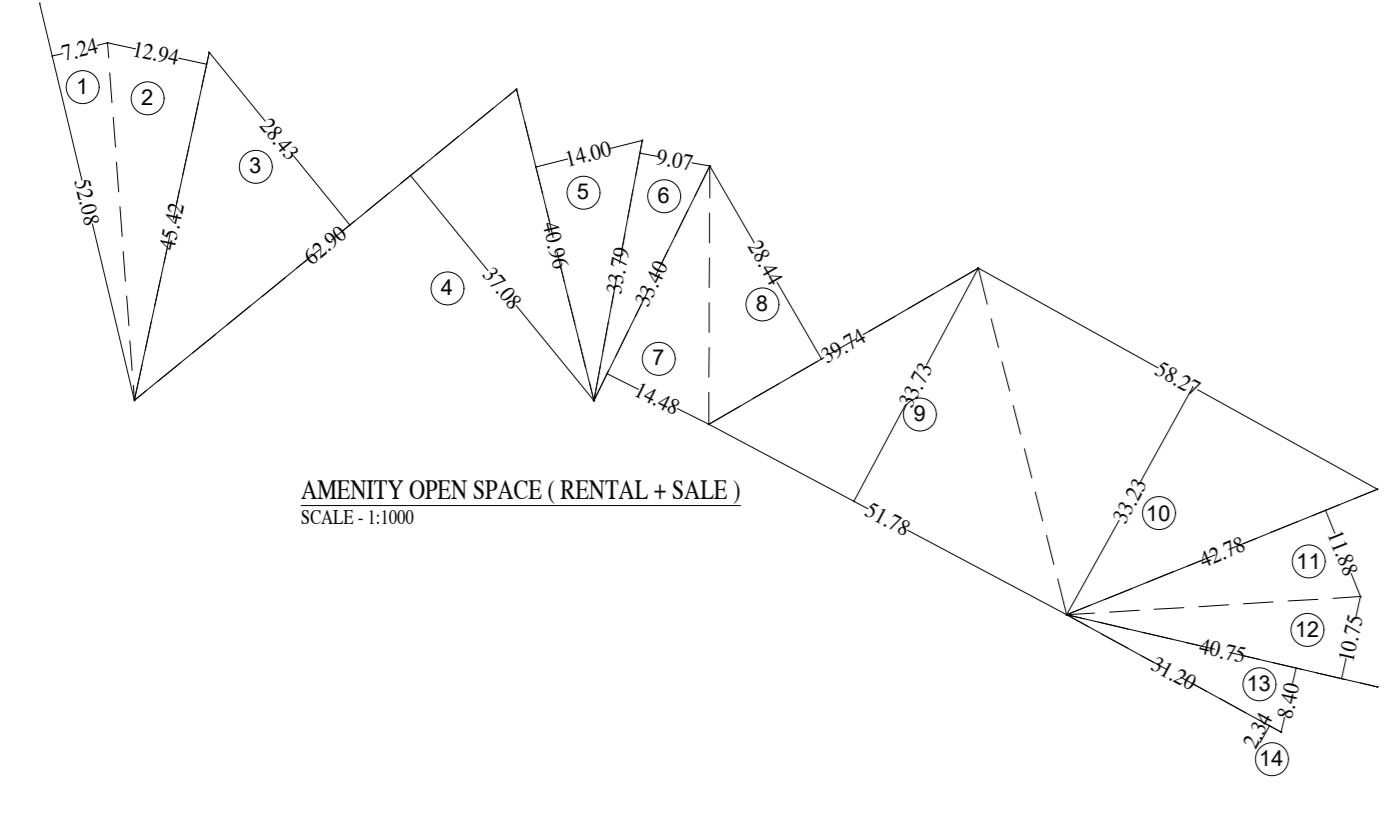

AMENITY OPEN SPACE (SALE + RENTAL)			
ADDITION			
1	52.08 x 7.24 x 0.50 =	188.53	SQ.MT
2	45.42 x 12.94 x 0.50 =	293.87	SQ.MT
3	62.90 x 28.43 x 0.50 =	894.12	SQ.MT
4	62.90 x 37.08 x 0.50 =	1166.18	SQ.MT
5	49.96 x 14.00 x 0.50 =	296.72	SQ.MT
6	33.79 x 9.07 x 0.50 =	153.24	SQ.MT
7	33.40 x 14.48 x 0.50 =	241.82	SQ.MT
8	39.74 x 28.44 x 0.50 =	565.10	SQ.MT
9	51.78 x 33.73 x 0.50 =	873.27	SQ.MT
10	58.27 x 33.23 x 0.50 =	968.16	SQ.MT
11	42.78 x 11.88 x 0.50 =	254.11	SQ.MT
12	40.75 x 10.75 x 0.50 =	219.03	SQ.MT
13	40.75 x 8.40 x 0.50 =	171.15	SQ.MT
14	31.20 x 2.34 x 0.50 =	36.50	SQ.MT
TOTAL		6311.80	SQ.MT

AMENITY AREA STATEMENT			
TOTAL AMENITY REQUIRED			
126231.00	X	5.0%	= 6311.55
AMENITY PROVIDED			
RENTAL AMENITY	=	3155.77	
SALE AMENITY	=	9467.33	
TOTAL AMENITY PROVIDED	=	12623.10	

ROAD AREA UNDER NH-17			
ADDITION			
1	33.01 x 13.64 x 0.50 =	225.13	SQ.MT
2	30.95 x 16.51 x 0.50 =	255.49	SQ.MT
3	17.12 x 10.44 x 0.50 =	89.38	SQ.MT
TOTAL		570.00	SQ.MT

LINE AREA DIA. FOR ROAD AREA UNDER NH17
SCALE 1:500

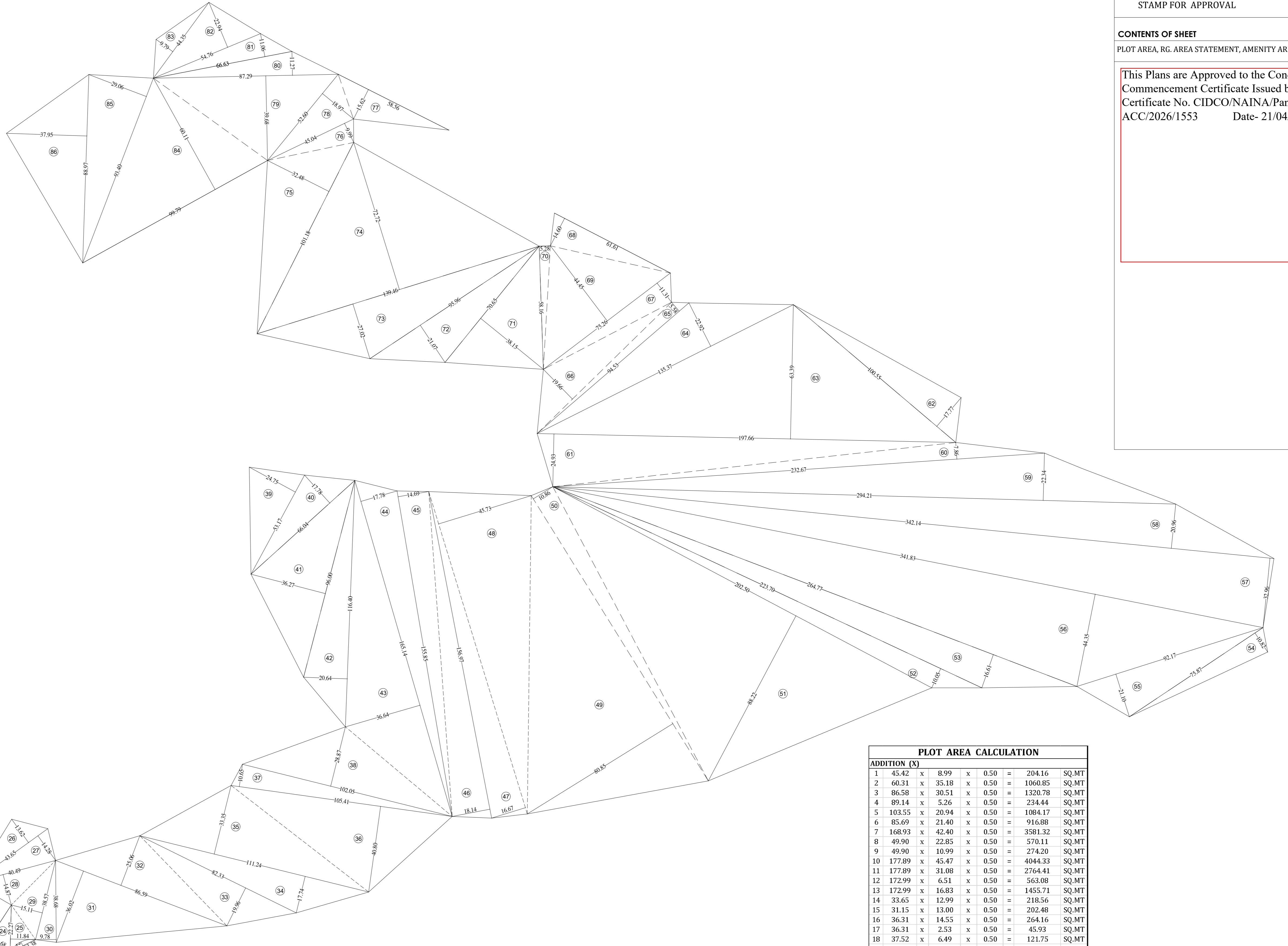

PLOT AREA CALCULATION			
ADDITION (X)			
1	45.42 x 8.99 x 0.50 =	204.16	SQ.MT
2	46.31 x 35.18 x 0.50 =	1646.85	SQ.MT
3	86.58 x 30.51 x 0.50 =	1320.78	SQ.MT
4	89.14 x 5.26 x 0.50 =	234.44	SQ.MT
5	103.55 x 20.94 x 0.50 =	1084.17	SQ.MT
6	85.69 x 21.40 x 0.50 =	916.88	SQ.MT
7	168.93 x 42.40 x 0.50 =	3581.32	SQ.MT
8	49.90 x 22.85 x 0.50 =	570.11	SQ.MT
9	49.90 x 10.99 x 0.50 =	274.20	SQ.MT
10	177.89 x 45.47 x 0.50 =	4044.33	SQ.MT
11	177.89 x 31.08 x 0.50 =	2764.41	SQ.MT
12	172.99 x 6.51 x 0.50 =	563.08	SQ.MT
13	172.99 x 16.83 x 0.50 =	1455.71	SQ.MT
14	33.65 x 12.99 x 0.50 =	218.56	SQ.MT
15	31.15 x 13.00 x 0.50 =	202.48	SQ.MT
16	36.31 x 14.55 x 0.50 =	264.16	SQ.MT
17	36.31 x 2.53 x 0.50 =	45.93	SQ.MT
18	37.52 x 6.49 x 0.50 =	121.75	SQ.MT
19	43.30 x 12.00 x 0.50 =	259.80	SQ.MT
20	14.29 x 6.51 x 0.50 =	46.51	SQ.MT
21	11.88 x 10.52 x 0.50 =	62.49	SQ.MT
22	11.88 x 1.57 x 2/3 =	12.43	SQ.MT
23	13.10 x 4.81 x 0.50 =	31.51	SQ.MT
24	24.89 x 11.68 x 0.50 =	145.36	SQ.MT
25	22.27 x 11.84 x 0.50 =	131.84	SQ.MT
26	43.65 x 13.62 x 0.50 =	297.26	SQ.MT
27	43.65 x 14.28 x 0.50 =	311.66	SQ.MT
28	40.49 x 14.87 x 0.50 =	301.04	SQ.MT
29	38.57 x 15.11 x 0.50 =	291.40	SQ.MT
30	26.42 x 9.08 x 0.50 =	119.99	SQ.MT
31	86.59 x 36.02 x 0.50 =	1559.49	SQ.MT
32	86.59 x 25.06 x 0.50 =	1084.97	SQ.MT
33	82.33 x 19.96 x 0.50 =	821.65	SQ.MT
34	111.24 x 17.74 x 0.50 =	986.70	SQ.MT
35	111.24 x 33.35 x 0.50 =	1854.93	SQ.MT
36	105.41 x 40.80 x 0.50 =	2150.36	SQ.MT
37	105.41 x 10.65 x 0.50 =	561.31	SQ.MT
38	102.65 x 28.87 x 0.50 =	1481.09	SQ.MT
39	53.17 x 24.75 x 0.50 =	657.98	SQ.MT
40	66.04 x 17.78 x 0.50 =	587.10	SQ.MT
41	96.00 x 36.27 x 0.50 =	1740.96	SQ.MT
42	116.40 x 20.64 x 0.50 =	1201.25	SQ.MT
43	165.14 x 36.64 x 0.50 =	3025.36	SQ.MT
44	165.14 x 17.78 x 0.50 =	1468.09	SQ.MT
45	155.85 x 14.69 x 0.50 =	1144.72	SQ.MT
46	156.97 x 18.14 x 0.50 =	1423.72	SQ.MT
47	159.16 x 16.67 x 0.50 =	1326.60	SQ.MT
48	159.16 x 45.73 x 0.50 =	3639.19	SQ.MT
49	158.49 x 80.85 x 0.50 =	6406.96	SQ.MT
50	158.49 x 10.86 x 0.50 =	860.60	SQ.MT
51	202.50 x 88.22 x 0.50 =	8932.28	SQ.MT
52	232.70 x 10.05 x 0.50 =	1124.09	SQ.MT
53	264.77 x 16.61 x 0.50 =	2198.91	SQ.MT
54	75.87 x 10.82 x 0.50 =	410.46	SQ.MT
55	92.17 x 21.10 x 0.50 =	972.39	SQ.MT
56	341.83 x 44.35 x 0.50 =	7580.08	SQ.MT
57	342.14 x 32.96 x 0.50 =	5688.47	SQ.MT
58	342.14 x 20.64 x 0.50 =	3536.63	SQ.MT
59	294.21 x 22.34 x 0.50 =	3286.33	SQ.MT
60	232.67 x 7.86 x 0.50 =	914.39	SQ.MT
61	197.66 x 24.93 x 0.50 =	2463.83	SQ.MT
62	105.55 x 17.77 x 0.50 =	933.39	SQ.MT
63	197.66 x 63.39 x 0.50 =	6264.83	SQ.MT
64	135.37 x 22.92 x 0.50 =	1551.34	SQ.MT
65	94.53 x 5.58 x 0.50 =	263.72	SQ.MT
66	88.71 x 19.66 x 0.50 =	872.02	SQ.MT
67	75.26 x 11.31 x 0.50 =	426.60	SQ.MT
68	61.61 x 14.60 x 0.50 =	449.75	SQ.MT
69	75.26 x 44.45 x 0.50 =	1672.65	SQ.MT
70	58.16 x 5.28 x 0.50 =	153.54	SQ.MT
71	70.65 x 38.15 x 0.50 =	1347.65	SQ.MT
72	95.96 x 21.07 x 0.50 =	1010.94	SQ.MT
73	139.46 x 27.02 x 0.50 =	1884.10	SQ.MT
74	139.46 x 72.72 x 0.50 =	5070.77	SQ.MT
75	101.18 x 32.48 x 0.50 =	1643.16	SQ.MT
76	45.04 x 9.99 x 0.50 =	224.97	SQ.MT
77	58.56 x 15.62 x 0.50 =	457.35	SQ.MT
78	52.60 x 18.97 x 0.50 =	498.91	SQ.MT
79	87.29 x 39.68 x 0.50 =	1731.83	SQ.MT
80	87.29 x 11.27 x 0.50 =	491.88	SQ.MT
81	66.63 x 11.06 x 0.50 =	368.46	SQ.MT
82	54.76 x 22.94 x 0.50 =	628.10	SQ.MT
83	44.35 x 9.79 x 0.50 =	217.09	SQ.MT
84	99.79 x 60.11 x 0.50 =	2999.19	SQ.MT
85	93.40 x 29.06 x 0.50 =	1357.10	SQ.MT
86	80.97 x 37.95 x 0.50 =	1569.21	SQ.MT
TOTAL		126236.21	SQ.MT
DEDUCTION (Y)			
a	7.64 x 1.37 x 2/3 =	6.98	SQ.MT
b	3.30 x 2.04 x 2/3 =	19.20	SQ.MT
TOTAL		25.17	SQ.MT
TOTAL AREA OF PLOT (X-Y)		126211.04	SQ.MT

RENTAL R.G. AREA STATEMENT IN SQ.MT.			
R.G. PROVIDED			
R.G. 6	=	2035.42	
R.G. 7	=	310.21	
R.G. 8	=	227.02	
R.G. 9	=	382.21	
R.G. 10	=	128.74	
R.G. 11	=	418.45	
R.G. 12	=	426.07	
R.G. 13	=	497.04	
R.G. 14	=	1496.26	
R.G. 15	=	250.91	
R.G. 16	=	726.5	
R.G. 17	=	534.20	
R.G. 18	=	88.70	
R.G. 19	=	88.70	
R.G. 20	=	609.35	
R.G. 21	=	1524.38	
TOTAL R.G. PROVIDED	=	9950.06	

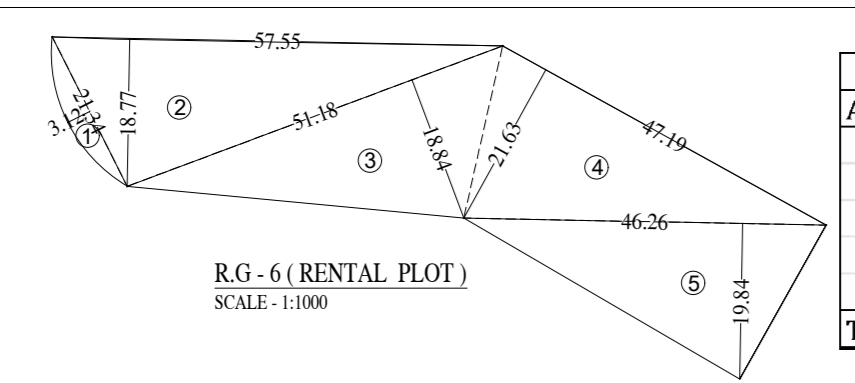

R.G. 6 AREA CALCULATION (RENTAL)			
ADDITION			
1	21.34 x 3.12 x 0.66 =	43.94	SQ.MT
2	57.55 x 18.77 x 0.50 =	540.11	SQ.MT
3	51.18 x 18.04 x 0.50 =	462.12	SQ.MT
4	47.19 x 21.63 x 0.50 =	510.36	SQ.MT
5	46.26 x 19.84 x 0.50 =	458.90	SQ.MT
TOTAL		2035.42	SQ.MT

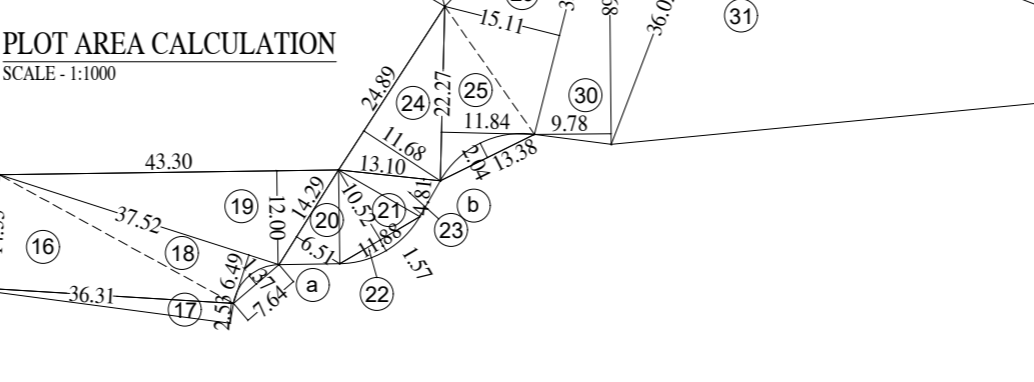

SALE R.G. AREA CALCULATION

R.G. 1 AREA CALCULATION (SALE)			
ADDITION			
1	29.50 x 10.63 x 0.50 =	156.79	SQ.MT
2	26.42 x 9.08 x 0.50 =	119.99	SQ.MT
3	26.42 x 16.61 x 0.50 =	219.4	SQ.MT
4	41.28 x 12.52 x 0.50 =	258.4	SQ.MT
TOTAL		754.57	SQ.MT
DEDUCTION			
a	23.57 x 1.95 x (2/3) =	26.74	SQ.MT
b	16.10 x 1.18 x (2/3) =	12.67	SQ.MT
TOTAL		39.41	SQ.MT
TOTAL AREA		715.16	SQ.MT

SALE R.G. AREA STATEMENT			
R.G. 1	=	715.16	
R.G. 2	=	1091.66	
R.G. 3	=	570.11	
R.G. 4	=	1861.19	
R.G. 5	=	1092.30	
TOTAL R.G. PROVIDED	=	5330.42	

R.G. 2 AREA CALCULATION (SALE)			
ADDITION			
1	61.19 x 16.94 x 0.50 =	518.28	SQ.MT
2	61.91 x 9.24 x 0.50 =	286.11	SQ.MT
3	61.91 x 9.28 x 0.50 =	287.26	SQ.MT
TOTAL		1091.66	SQ.MT

R.G. 3 AREA CALCULATION (SALE)			
ADDITION			
1	24.10 x 9.16 x 0.50 =	110.38	SQ.MT
2	29.51 x 18.35 x 0.50 =	270.75	SQ.MT
3	33.14 x 10.39 x 0.50 =	172.16	SQ.MT
4	10.68 x 10.64 x 0.50 =	56.42	SQ.MT
5	12.04 x 0.37 x 0.50 =	2.23	SQ.MT
TOTAL		612.34	SQ.MT
DEDUCTION			
a	23.02 x 2.58 x 0.67 =	39.59	SQ.MT
b	10.68 x 0.37 x 0.67 =	2.61	SQ.MT
TOTAL		42.23	SQ.MT
TOTAL AREA		570.11	SQ.MT

R.G. 4 AREA CALCULATION (SALE)			
ADDITION			
1	43.65 x 13.62 x 0.50 =	297.26	SQ.MT
2	43.65 x 19.13 x 0.50 =	417.42	SQ.MT
3	39.93 x 9.78 x 0.50 =	195.26	SQ.MT
4	29.69 x 19.12 x 0.50 =	283.84	SQ.MT
5	39.30 x 14.89 x 0.50 =	292.49	SQ.MT
6	39.30 x 19.08 x 0.50 =	374.92	SQ.MT
TOTAL		1861.19	SQ.MT

R.G. 5 AREA CALCULATION (SALE)			
ADDITION			
1	48.98 x 19.93 x 0.50 =	488.09	SQ.MT
2	51.62 x 20.14 x 0.50 =	519.81	SQ.MT
3	51.62 x 3.27 x 0.50 =	84.40	SQ.MT
TOTAL		1092.30	SQ.MT

R.G. 18 AREA CALCULATION			
ADDITION			
1	19.69 x 9.01 x 0.50 =	88.70	SQ.MT
TOTAL		88.70	SQ.MT

R.G. 15 AREA CALCULATION			
ADDITION			
1	44.16 x 7.98 x 0.50 =	176.20	SQ.MT
2	41.06 x 3.42 x 0.50 =	70.21	SQ.MT
3	6.25 x 1.09 x 0.66 =	4.50	SQ.MT
TOTAL		250.91	